

Built on Tradition



Highland Tank®



FuelShield

HT-6102

Fuel Management System

FuelShield is the most innovative and accurate wireless automated fuel management system. FuelShield is designed for stationary or mobile applications and suits any size fueling operation.

FuelShield can be used in retrofit applications to existing pumping systems or designed into new facilities. A single FuelShield-PLUS can be configured to process data from up to 8 separate level probes and control dispensing at 6 independent locations.

High-LINK® Integrated Systems couple superior steel tank products with state-of-the-art electronic management devices and SCL's proprietary software providing real-time data to optimize usage and transfer of any liquid operation.

FuelShield Features:

- Track every fuel transaction by vehicle, driver, fuel type, amount, cost, date, and time
- Manage fuel transportation, receipt, dispensing, and consumption
- Secure and convenient multi-user web dashboard platform
- Full visibility of your entire operation from anywhere, anytime, on any device
- High-LINK platform for go-anywhere system management

Benefits:

- Eliminate fraud and human errors
- Authorize vehicles, equipment and operator fuel dispensing
- Cost-saving minimal installation
- Optimize fuel consumption
- Reporting, analytics, alerts and more with High-LINK software platform



Construction:

- Welded aluminum
- Powder coated
- Sloped top to shed water/snow
- Neoprene access panel seal

Options

- Emergency Stop
- Cabinet Heater

Controls

- Up to eight (8) hoses
- Unlimited drivers and vehicles
- Up to eight (8) level probes

User ID Options

- Dallas Key
- HID
- Magnetic Card
- PIN Pad

Vehicle ID Options

- Dallas Key
- HID
- RFID
- Magnetic Card
- PIN
- Barcode Scanner

Communication Options

- Satellite
- Wi-Fi
- GPRS
- LAN

The FuelShield software module provides over 50 standard reports and multiple data filtering functions to provide users with big data analysis capabilities. User-defined custom reports are also available for tailored reporting.

Other FuelShield models are available for specific applications, limited service and added capability.

- FuelShield Plus - Includes LevelShield liquid level monitoring
- FuelShield Mini - 1-4 hoses, with various options
- FuelShield-RT - Remote Access Cabinet

FuelShield Specifications

Physical

- Cabinet Size 15.25" W x 9.0" D x 64.0" H
- Base Plate Footprint: 16.5" W x 10.0" D
- Foundation Connection:

Operating Voltages:

- 12/24 VDC or 110-230 VAC

Operating Temperature Range:

- Minus 32° to 135° F without heater
- Minus 55° to 135° F with optional heater

Control Panel Standard Features

- Keypad
- LCD Display
- Dallas Key Reader

Access Panel (Locking, Rear):

- 13.625" W x 35.0" HD

System Bypass Key

Pump Controls

- Relay Contact Rating: 15 AMPS
- Pulsar Type: Contact closure- dry contact
- Pulsar Input: 2-wire
- Pulsar Speed: 1000HZ

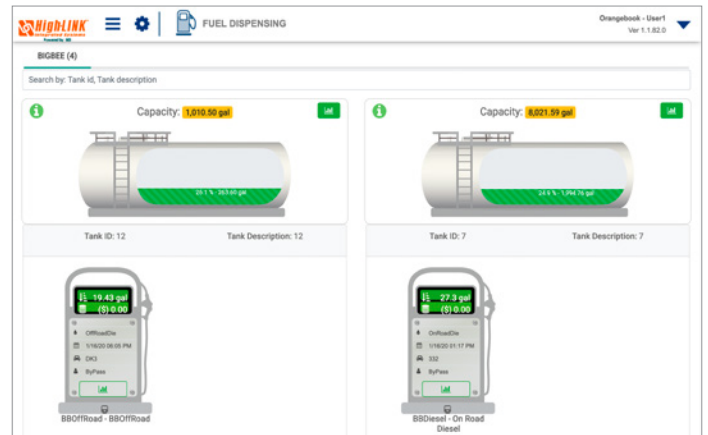

Stoystown, PA

One Highland Rd.
Stoystown, PA 15563
(814) 893-5701

Manheim, PA

4535 Elizabethtown Rd.
Manheim, PA 17545
(717) 664-0600

Watervliet, NY

958 19th St.
Watervliet, NY 12189
(518) 273-0801

Greensboro, NC

2700 Patterson St.
Greensboro, NC 27407
(336) 218-0801

Friedens, PA

1510 Stoystown Rd.
Friedens, PA 15541
(814) 443-6800

Clarkston, MI

4701 White Lake Rd.
Clarkston, MI 48346
(248) 625-8700

Mancelona, MI

9517 Lake St.
Mancelona, MI 49659
(231) 587-8412